

# Design Principles

The vision for Ropes Creek is to create a community that demonstrates current best practice sustainable urban design, integrates with Ropes Crossing and surrounding communities and supports local economic development.

## Urban Design Principles

### Mixed Use

A mix of land uses, including areas of employment carefully integrated with residential. Adjacent Ropes Crossing Village Centre will provide retail, learning and community facilities.



### Street Layout and Access

A well connected and easily understood network for vehicles, bikes and pedestrians with access opportunities to the Village Centre and employment area. Businesses and residents will be within a short walk of a bus stop.



### Streetscapes

Streets will be pedestrian and cycle friendly. They will include high quality landscaping, the planting of new street trees and Water Sensitive Urban Design elements such as grassed swales.



### Energy and Water Efficient Design

Buildings, open space and streets will promote current best practice techniques for conserving the use of energy and water. Recycled water will be utilised throughout the development for uses such as watering and toilet flushing.

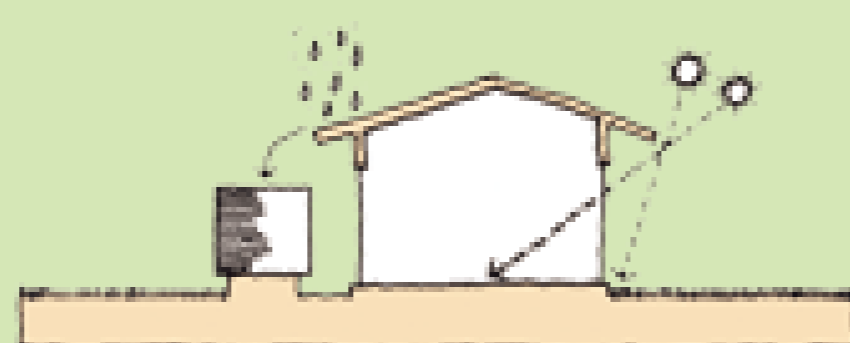

### Attention to Detail / Contemporary Design

The Ropes Creek Precinct will incorporate design controls, influencing streetscapes, open spaces, buildings and vehicular access, to ensure the creation of a high quality environment.

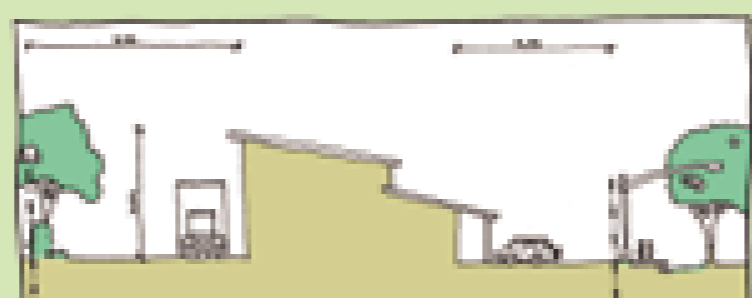

## Getting the Fundamentals Right

There are four fundamental principles upon which the Ropes Creek Precinct will be built:

**Sustainability:** A socially, environmentally and economically viable employment community, both now and in the future.

**Balance:** Consideration of economic, social and ecological factors in decision-making.

**Place:** A destination that has a unique character.

**Choice:** A range of housing and employment choices with access to transport, recreation and services.

### Safe and Secure Place

The design of streets and open spaces will encourage safe and usable open space areas where people can meet and interact.

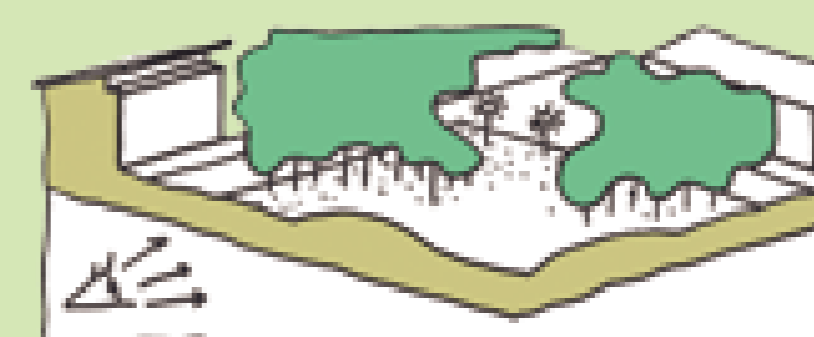

### Housing and Allotment Choice

A variety of housing choices will be provided to assist in the creation of a diverse community. Housing and business allotment sizes will meet the needs of the market and assist in the support of a diverse local economy.

